



High performance vacuum pump made in Japan

For Septic Tank Trucks

T 6 0 A - J 4 0 S



Good Durability !



T 4 5 - J 1 0 S



Deomagic®VC1 Oil
Deodorant pump oil

TOHO VACUUM PUMP SERIES

SPECIFICATION	T32A—J10S	T45A—J10S	T56A —J10S
DISPLACEMENT	3148 cc/rev	4418 cc/ rev	5584 cc/ rev
EXHAUST VELOCITY	2200 L/min (2.2m ³ /min)	2650 L/min (2.65m ³ /min)	2790L/min(2.79m ³ /min)
ROTATION	600 rpm ~ 800rpm	500 rpm ~ 700rpm	400rpm ~ 600rpm
PORT SIZE	φ50mm	φ55mm	φ55mm
WEIGHT	53 kg	65 kg	93kg
DIRECTION OF ROTATION	COUNTERCLOCKWISE (DRIVE SHAFT END VIEW)	COUNTERCLOCKWISE (DRIVE SHAFT END VIEW)	COUNTERCLOCKWISE (DRIVE SHAFT END VIEW)

SPECIFICATION	T56A —J10W	T60A —J40S	T60A —J40W
DISPLACEMENT	5584 cc/ rev	5260 cc/ rev	5260 cc/ rev
EXHAUST VELOCITY	2790L/min(2.79m ³ /min)	2890 L/min (2.89m ³ /min)	2890 L/min (2.89m ³ /min)
ROTATION	400rpm ~ 600rpm	400rpm ~ 600rpm	400rpm ~ 600rpm
PORT SIZE	φ55mm	φ55mm	φ55mm
WEIGHT	95kg	75 kg	78 kg
DIRECTION OF ROTATION	COUNTERCLOCKWISE (DRIVE SHAFT END VIEW)	COUNTERCLOCKWISE (DRIVE SHAFT END VIEW)	COUNTERCLOCKWISE (DRIVE SHAFT END VIEW)

TOHO CAR Vacuum Pump Parts List

T32 · T45 · T56 · T60

Vacuum Pump A'ssy

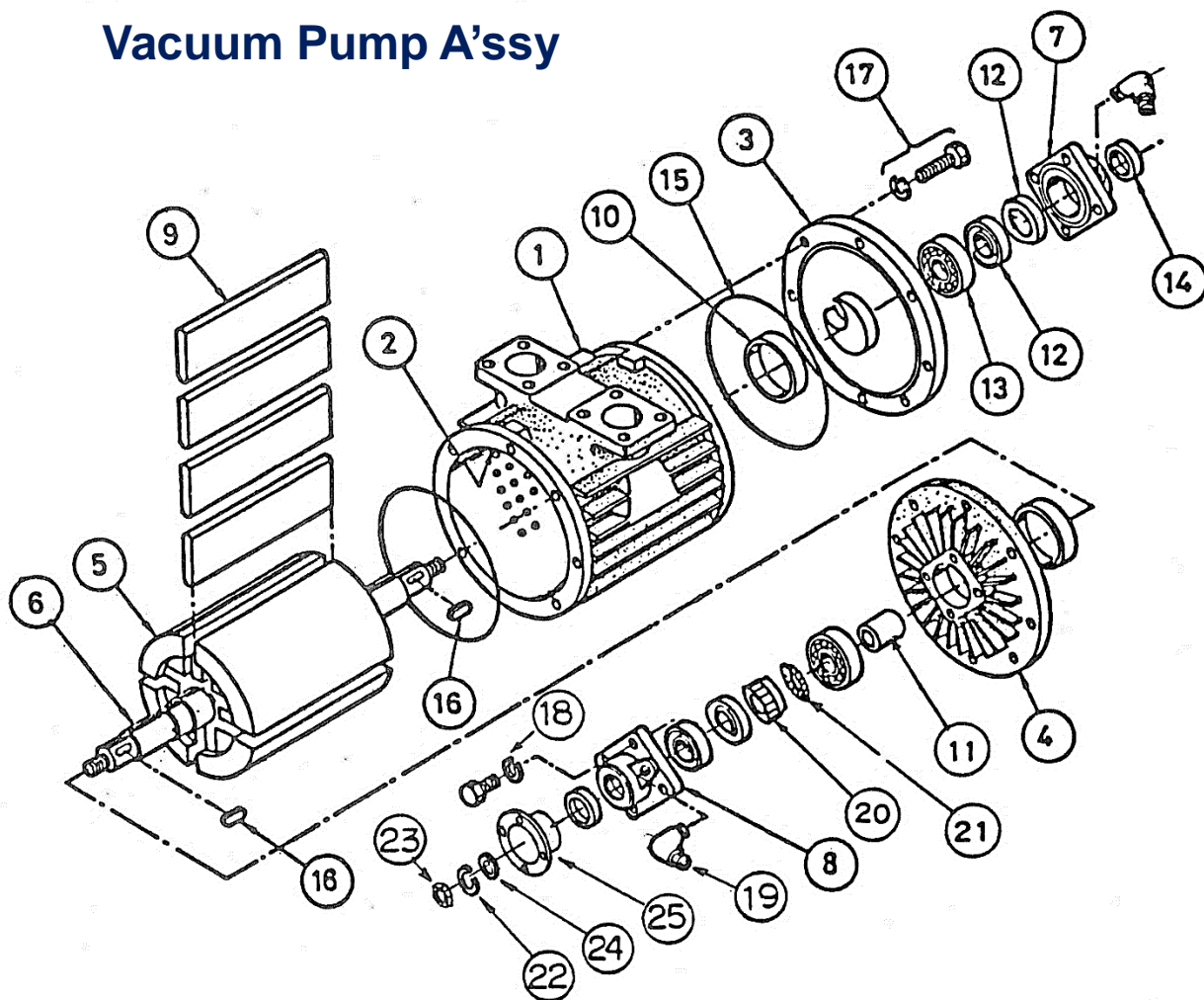

Part name		Part name		Part name	
1	Vacuum Pump Main Unit	11	Sleeve	21	Paper Packing Material
2	Inner Cylinder Assy	12	O-ring	22	Oil Seal (Z Seal)
3	Front Cover	13	Oil Seal	23	Rear Collar
4	Rear Cover	14	Oil Seal	24	Bearing Washer
5	Rotor	15	Ball Bearing	25	Bearing Nut
6	Rotor Shaft	16	Key (Double-sided Round), S45C		
7	Bearing Cover	17	Hexagonal headed bolt		
8	Bearing Cover	18	Hexagonal headed bolt		
9	Vane	19	Street Elbow		
10	Guide Ring	20	O-ring (silicone)		