

Heavy-duty under-body tipping gear for 10-wheel and 12-wheel trucks, and 3-axle full trailers. Manufactured and assembled in Thailand, under strict design and quality standards of ShinMaywa Japan.

Key Features

- ★ **Twin-plate tension link; stronger than welded single plate type**
- ★ **Screw type rod cover; higher resistance to over-tipping than bolted type**
- ★ **Lightest weight in class**
- ★ **Cylinder bore: 220mm, rod diameter: 100mm**



PATENT PENDING

"Tentsuki" is the registered trademark of ShinMaywa.



The history of "Tentsuki" started in 1971.



Standard kit details

- A-1 Cylinder Ass'y
- A-2 Lift Arm
- A-3 Tension Link
- A-4 Trunnion Bracket
- A-5 Body Bracket
- B Support Ass'y

* High & low pressure port flanges are included.

** Gear pump and other accessories are available upon request.

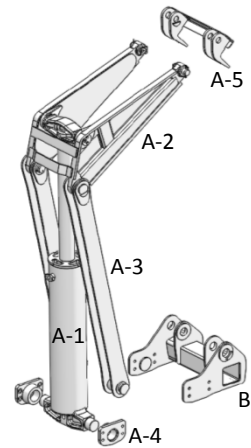

Installation examples

Body length ("L", mm)	Hinge overhang ("R", mm)	Load center to hinge ("l", mm)	Tipping angle & Trunnion to hinge ("T", mm) Max. lifting capacity (t)		
			51°/T=2,500	50°/T=2,600	48°/T=2,700
5,700	800	2,050	41.6	43.0	44.4
6,000	880	2,120	40.2	41.6	42.9
6,500	750	2,500	34.1	35.3	36.4
7,000	800	2,700	31.6	32.7	33.7

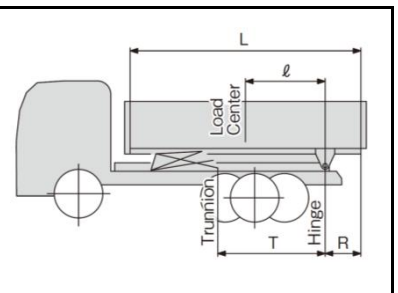

Hoist specifications

Cylinder bore x stroke	220 x 860 mm
Rod diameter	100 mm
Retracted cylinder length	1,239 mm (eye to eye)
Max. pressure	20.6 MPa (210 kgf/cm ²)
Mass (Support Ass'y included)	500 kg

Dimensions

L	1,725 mm (Support ASSY included)
W	574 mm
H	470 mm
X	572 mm

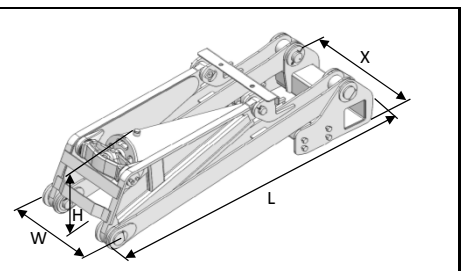

Thai ShinMaywa Co., Ltd.

A subsidiary of ShinMaywa Industries, Ltd., Japan.

www.shinmaywa.co.jp/thai/

199 Moo 12 Petchkasem 120 Rd., Om-noi
Samutsakorn 74130 Thailand

TEL: +66-2420-9860 / FAX: +66-2420-9863
E-mail: sales.tsmc@shinmaywa.co.jp