

Under-body tipping gear for medium and large size 6-wheel (4x2) trucks.

Manufactured and assembled in Thailand, under design and quality standards of ShinMaywa Japan.

## Key Features

- ★ **Cylinder bore: 160mm, rod diameter: 70mm**
- ★ **Screw type rod cover; higher resistance to over-tipping than bolted type** PATENT PENDING
- ★ **Twin-plate tension link; narrower hoist width than single plate type, strength equivalent**
- ★ **Certified for Thai Industrial Standard (TIS. 975-2538)**

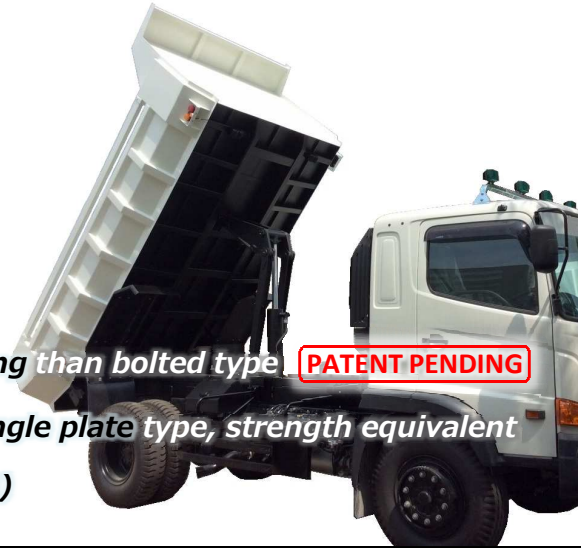

### Standard kit details

- A-1 Cylinder Ass'y
- A-2 Lift Arm
- A-3 Tension Link
- A-4 Trunnion Bracket
- A-5 Body Bracket
- B Support Ass'y

\* High & low pressure port flanges are included.

\*\* Gear pump and other accessories are available upon request.

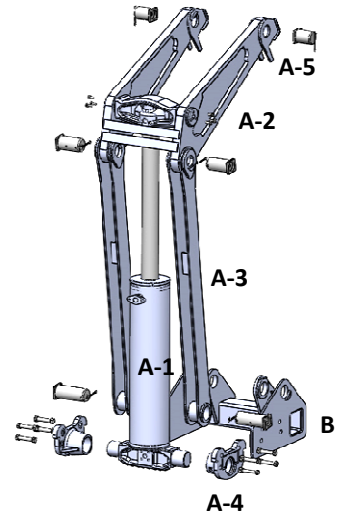

### Installation examples

Body length ("L", mm)	Hinge overhang ("R", mm)	Load center to hinge ("ℓ", mm)	Tipping angle & Trunnion to hinge ("T", mm) Max. lifting capacity (t)		
			56°/T=1,650	55°/T=1,700	53°/T=1,750
3,500	400	1,350	16.0	16.3	16.6
4,000	600	1,400	15.4	15.7	16.0
4,500	650	1,600	13.3	13.6	13.9
4,800	700	1,700	12.5	12.8	13.0

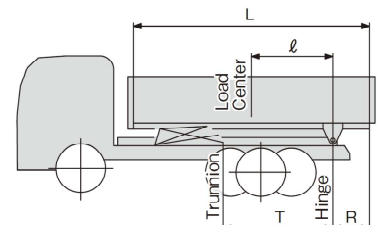

### Hoist specifications

Cylinder bore x stroke	160 x 584 mm
Rod diameter	70 mm
Retracted Cylinder Length	1,008mm (Eye to Eye)
Max. pressure	13.7 MPa (140 kgf/cm <sup>2</sup> )
Mass (Support Ass'y included)	262 kg

### Dimensions

L	1,451 mm
W	464 mm
H	430 mm
X	480 mm
(Support Ass'y included)	

